

Setup Sheet for Program 13707

JOB DESCRIPTION: OP1

DOCUMENT PATH: Coaster 7th v13

NOTES:

X0 Y0 Center of Part
Z0 Top of Part

Setup

WCS: #0

STOCK:

DX: 5in

DY: 5in

DZ: 1in

PART:

DX: 4.5in

DY: 4.5in

DZ: 0.85in

STOCK LOWER IN WCS #0:

X: -2.5in

Y: -2.5in

Z: -1in

STOCK UPPER IN WCS #0:

X: 2.5in

Y: 2.5in

Z: 0in

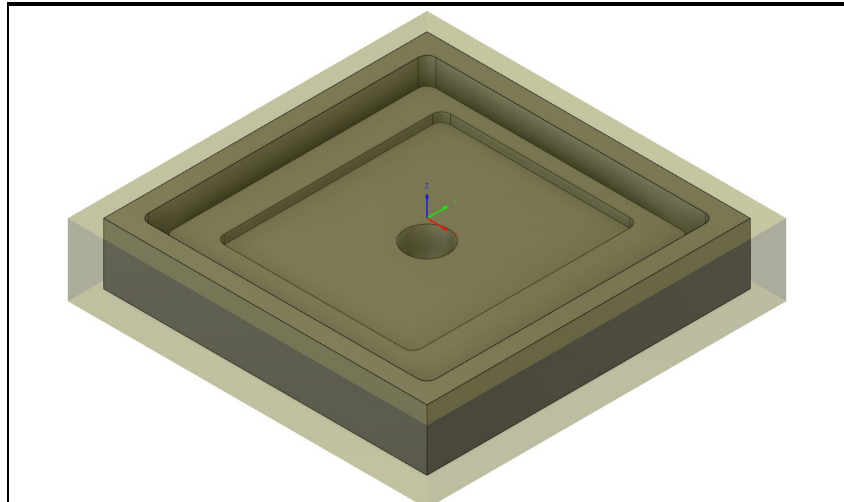

Total

NUMBER OF OPERATIONS: 5

NUMBER OF TOOLS: 2

TOOLS: T2 T3

MAXIMUM Z: 0.6in

MINIMUM Z: -0.95in

MAXIMUM FEEDRATE: 126.06in/min

MAXIMUM SPINDLE SPEED: 7000rpm

CUTTING DISTANCE: 1434.553in

RAPID DISTANCE: 122.003in

ESTIMATED CYCLE TIME: 25m:29s

Tools

T2 D2 L2

TYPE: flat end mill

DIAMETER: 0.5in

LENGTH: 1.1in

FLUTES: 3

DESCRIPTION: 1/2" Flat Endmill

MINIMUM Z: -0.95in

MAXIMUM FEED: 126.06in/min

MAXIMUM SPINDLE SPEED: 6500rpm

CUTTING DISTANCE: 836.596in

RAPID DISTANCE: 31.589in

ESTIMATED CYCLE TIME: 9m:46s (38.3%)

HOLDER: Maritool CAT40-ER32-2.35

VENDOR: Maritool

PRODUCT: CAT40-ER32-2.35

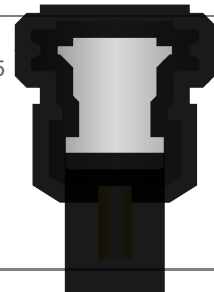

T3 D3 L3

TYPE: flat end mill	MINIMUM Z: -0.5in	HOLDER: Maritool CAT40-ER32-2.35
DIAMETER: 0.125in	MAXIMUM FEED: 40in/min	VENDOR: Maritool
LENGTH: 0.6in	MAXIMUM SPINDLE SPEED: 7000rpm	PRODUCT: CAT40-ER32-2.35
FLUTES: 3	CUTTING DISTANCE: 597.957in	
DESCRIPTION: 1/8" Flat Endmill	RAPID DISTANCE: 90.414in	
	ESTIMATED CYCLE TIME: 14m:58s (58.7%)	

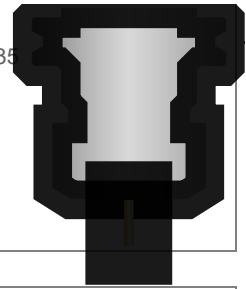
**Operations****Operation 1/5**

DESCRIPTION: Adaptive1	MAXIMUM Z: 0.6in
STRATEGY: Adaptive	MINIMUM Z: -0.315in
WCS: #0	MAXIMUM SPINDLE SPEED: 6500rpm
TOLERANCE: 0.004in	MAXIMUM FEEDRATE: 126.06in/min
STOCK TO LEAVE: 0.01in	CUTTING DISTANCE: 816.479in
MAXIMUM STEPDOWN: 0.175in	RAPID DISTANCE: 29.144in
OPTIMAL LOAD: 0.05in	ESTIMATED CYCLE TIME: 9m:31s (37.4%)
LOAD DEVIATION: 0.005in	COOLANT: Flood

T2 D2 L2

TYPE: flat end mill
DIAMETER: 0.5in
LENGTH: 1.1in
FLUTES: 3
DESCRIPTION: 1/2" Flat Endmill

**Operation 2/5**

DESCRIPTION: 2D Pocket2	MAXIMUM Z: 0.6in
STRATEGY: Pocket 2D	MINIMUM Z: -0.325in
WCS: #0	MAXIMUM SPINDLE SPEED: 7000rpm
TOLERANCE: 0.004in	MAXIMUM FEEDRATE: 40in/min
STOCK TO LEAVE: 0in	CUTTING DISTANCE: 178.406in
MAXIMUM STEPOVER: 0.05in	RAPID DISTANCE: 1.313in
	ESTIMATED CYCLE TIME: 4m:28s (17.5%)
	COOLANT: Flood

T3 D3 L3

TYPE: flat end mill
DIAMETER: 0.125in
LENGTH: 0.6in
FLUTES: 3
DESCRIPTION: 1/8" Flat Endmill

**Operation 3/5**

DESCRIPTION: 2D Pocket2 (3)	MAXIMUM Z: 0.6in
STRATEGY: Pocket 2D	MINIMUM Z: -0.2in
WCS: #0	MAXIMUM SPINDLE SPEED: 7000rpm
TOLERANCE: 0.004in	MAXIMUM FEEDRATE: 40in/min
STOCK TO LEAVE: 0in	CUTTING DISTANCE: 150.272in
MAXIMUM STEPOVER: 0.05in	RAPID DISTANCE: 24.415in
	ESTIMATED CYCLE TIME: 3m:46s (14.8%)
	COOLANT: Flood

T3 D3 L3

TYPE: flat end mill
DIAMETER: 0.125in
LENGTH: 0.6in
FLUTES: 3
DESCRIPTION: 1/8" Flat Endmill

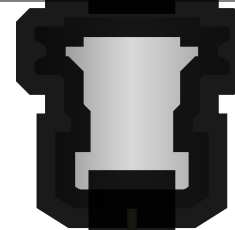
**Operation 4/5**

DESCRIPTION: 2D Pocket2 (2)	MAXIMUM Z: 0.6in
STRATEGY: Pocket 2D	MINIMUM Z: -0.5in
WCS: #0	MAXIMUM SPINDLE SPEED: 7000rpm
TOLERANCE: 0.004in	MAXIMUM FEEDRATE: 40in/min
STOCK TO LEAVE: 0in	CUTTING DISTANCE: 269.279in
MAXIMUM STEPDOWN: 0.1in	RAPID DISTANCE: 64.687in
MAXIMUM STEPOVER: 0.05in	ESTIMATED CYCLE TIME: 6m:45s (26.5%)
	COOLANT: Flood

T3 D3 L3

TYPE: flat end mill
DIAMETER: 0.125in
LENGTH: 0.6in
FLUTES: 3
DESCRIPTION: 1/8" Flat Endmill

**Operation 5/5**

DESCRIPTION: Bore1	MAXIMUM Z: 0.6in
STRATEGY: Bore	MINIMUM Z: -0.95in
WCS: #0	MAXIMUM SPINDLE SPEED: 6500rpm
TOLERANCE: 0in	MAXIMUM FEEDRATE: 126.06in/min
STOCK TO LEAVE: 0in	CUTTING DISTANCE: 20.118in
	RAPID DISTANCE: 2.445in
	ESTIMATED CYCLE TIME: 15s (1%)
	COOLANT: Flood

T2 D2 L2

TYPE: flat end mill
DIAMETER: 0.5in
LENGTH: 1.1in
FLUTES: 3
DESCRIPTION: 1/2" Flat Endmill

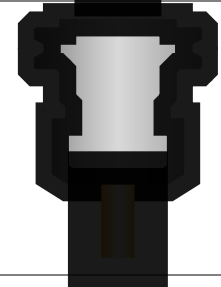
Generated by [Fusion 360 CAM 2.0.11680](#) Friday, April 01, 2022 10:15:11